

arched corner

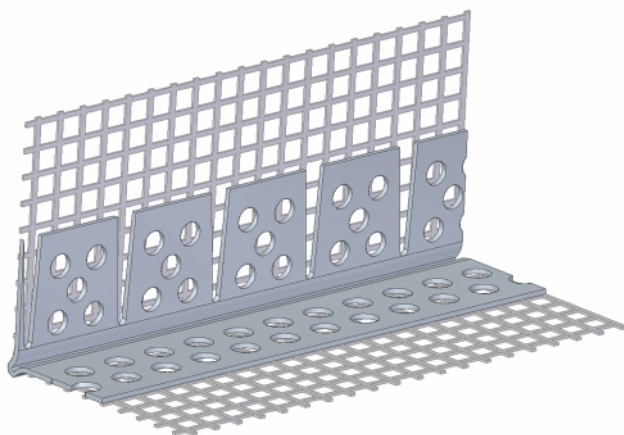

- used to strengthen and reinforce corners on inner arch curves
- suitable for ETICS systems
- protects edges against mechanical damage, prevents hair-line cracks
- profile crease makes it easy to smooth off plaster
- perforations on both sides assure that profile bonds strongly to levelling compound
- chemically stable, does not react with plaster

Material	Dimension	Ordering No.	Length	Packing
	mm		m	pcs
PVC	25 x 25 x 1 wgm100 x 100	D/38	2,5	20

Recommendation:

Before applying, the glass fibre on the sections (spaces) on the arch side must be trimmed up to the top of the section, frequency depending on the radius of the arch. The profile should be placed on the edge of the arch and fixed in place in a manner to suit the thickness of the plaster. When creating the arch the profile should be shaped gradually and evenly according to the radius of the arch. The profile must be placed onto a pre-stretched construction adhesive (levelling compound). The trimmed glass fibre strips must be reinforced with fabric from the front of the ETICS system or with 20 x 30 cm diagonal glass fibre strips.

Storage:

A horizontal storage position is recommended. Profiles packed into boxes must be stored in a dry environment, at a temperature between -5°C and +40°C. Maximum recommended storage time is 24 months.