

universal corner bead with mesh

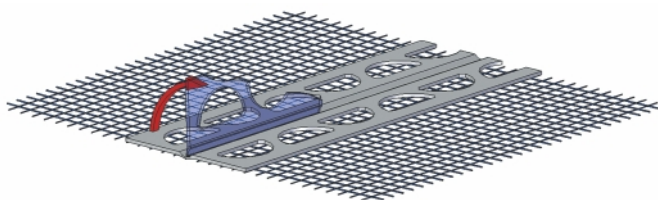

- reinforcement of corners and edges with an angle 90° up to 180°
- practical and easy to handle - the profile is delivered in rolls
- eliminates the need to connect the profile - the profile is delivered in rolls
- protects the corners, edges and jambs of windows and doors against mechanical damage
- aesthetic appeal - forms perfectly straight corners
- connects to the insulation system an integrated reinforcing fabric
- corner profiles with mesh cover over corner areas in optimum way
- chemically stable, not reacting with a plaster
- can be used instead of an aluminium profile with mesh

Material	Dimension	Ordering No.	Length	Packing
	mm		m	pcs
PVC	25 x 25 wgm 100x100	D/30	50	box
PVC	25 x 25 wgm 100x100	D/30.01	25	box

Recommendation:

Before using for the first time, open the box and push the end of the profile through the hole in the side of the box. When finished working, insert the free end of the profile into the slot at the bottom. At the place where you want to fit it, apply the levelling compound to the width of the integrated glass-fibre mesh of the profile. Before placing it on the levelling compound we recommend reshaping the profile to the minimal angle. Place the profiles onto the levelling compound and smooth off with a stainless-steel trowel. To shorten the profile use scissors designed for work with plastic profiles. Installation work must be performed within the temperature range +5°C to +30°C.

Storage:

The boxed profiles should be stored in a dry environment. Maximum recommended storage time is 24 months.