

corner bead with glass fibre mesh

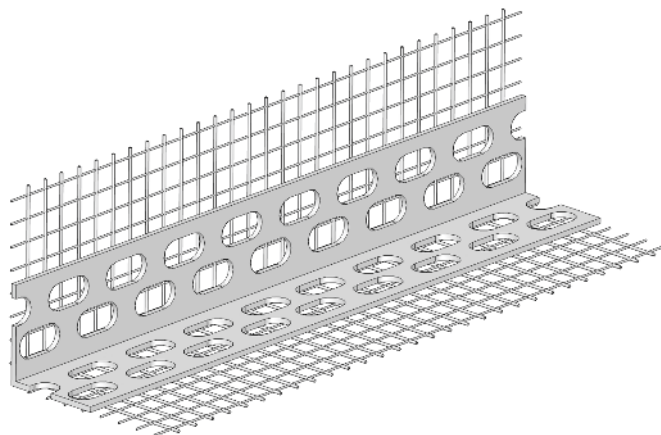

- protection of corners, edges against mechanical damage
- double-sided, perforated profiles
- chemically stable, not reacting with a plaster
- aesthetics – perfectly straight ending
- connecting of the profile with glass fibre mesh to reinforcing mesh fabric used on the thermal insulation system surface
- corner profiles with fabric cover over corner or edge areas in optimum way
- increasing of compression strength in the areas containing connections

Material	Dimension mm	Ordering No.	Length m	Packing pcs
PVC	23 x 23 wgm 100x100	D/03	2,5	50
PVC	23 x 23 wgm 100x150	D/03.3	2,5	50
PVC	23 x 23 wgm 80x120	D/03.4	2,5	50
PVC	23 x 23 wgm 100x150	D/03.7	2,5	100
PVC	23 x 23 wgm 80x120	D/03.8	2,5	100

Recommendation:

During the profiles connecting, the mesh overlapping part has to go over other profile.

Storage:

A horizontal storage position is recommended. The profiles need to be stored in a dry place the temperature range of -5°C to +40°C. Maximum recommended storage time is 24 months.